

Motorized Shade with Cables Installation Instructions

Tools Needed	Hardware Provided (per shade)	Hardware Needed
Drill Measuring Tape Pencil 2" Level Plumb Line 1/4" Masonry Drill Bit Hammer Linesmans Pliers Cable Cutters 10MM Wrench	Brackets (2) Motor with Star Bracket (1) Motor Bolts with Lock Washers (2) Bearing (1) Turnbuckles (2) Tie Wire Drives (Cable Anchors) (2) Cable Sleeves (4) Cables (2 per shade) (2) Remote (1 per order) Swaging Tool (1)	5/16" X 4 1/2 " Lag Screws or Appropriate (4 per shade) 3/8" Flat Washers or Appropriate (4 per shade) Wire Nuts

1. Measure

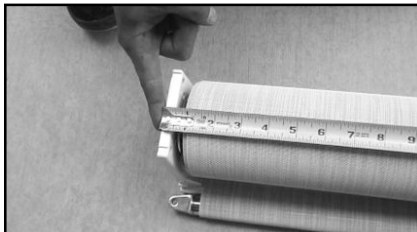

Measure space where shade will be installed, Identifying the shade's overall size.

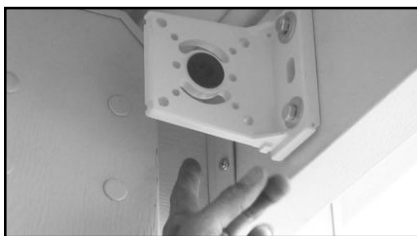

Make sure there is an even gap on both sides of where you will install your brackets. Decide where your brackets will hang and mark their location with a pencil.

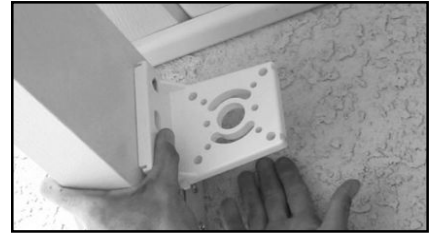

2. Install Brackets- Attach, Fix, Secure



Using appropriate install hardware, attach brackets to mounting surface. Insure brackets are level before securing screws.



3. Hang Tube With Fabric - 2 Person Job

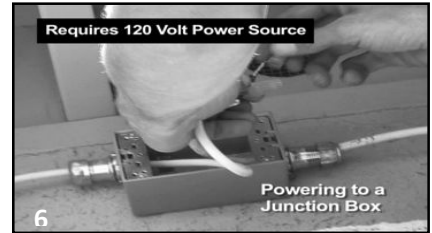
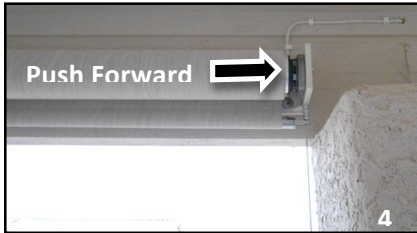
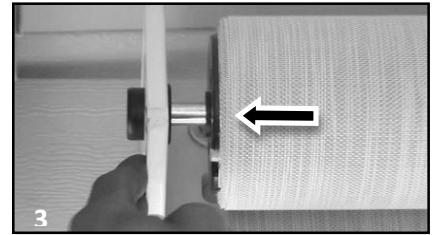

Remove bottom rail from pocket of fabric (#1) and motor clip from star bracket (#2); set aside. Slide plastic bearing (#3) onto non-operating side round pin end of shade. Hold tube with fabric up to brackets and slide the motor end of shade into star bracket (#4). Reinstall the motor clip (#5) onto the star bracket. Tie motor wire into electrical source (#6). Put bottom rail back into pocket of fabric.

4. Drill Holes For Cable Anchors



Use Plumb Line to hang from small hole in bracket down to floor. Mark spot with pencil for cable anchor. Drill hole with 1/4" masonry drill bit.

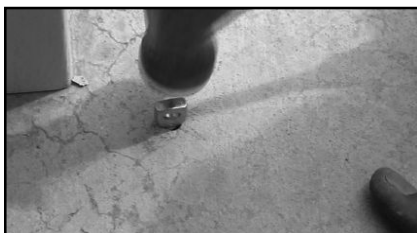

Hammer in tie wire drives. (You will repeat this whole process on the other side)

[NOTE: Tie wire drives should be hammered in as far as they can go.]

5. Attach Cables

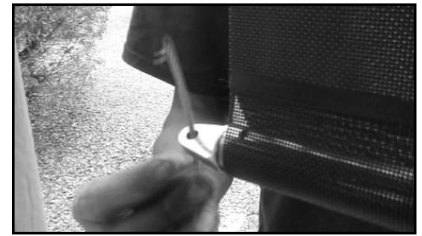

Open turnbuckles by unscrewing each end until $\frac{1}{4}$ " thread remains inside turnbuckle housing. Attach hook end of turnbuckle to tie wire drive. (It should be lying on the ground loosely attached on the ground). Slip cable through the eyelet of bottom rail.



Close turnbuckles to add tension to cables. (Hold top and turn buckle clockwise)

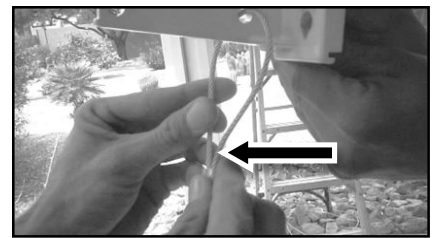
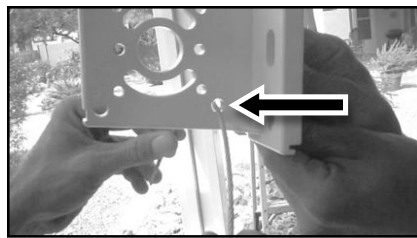
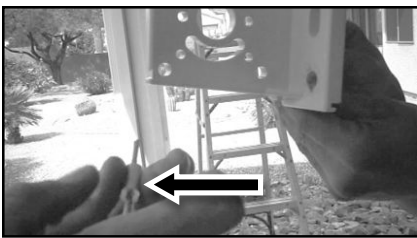

Feed one end of cable into cable sleeve, slip through eye of turnbuckle and feed it back into cable sleeve. **[Note: You will do this with the fabric tube already attached and secured. Feed cable into holes in each bracket that will line up with the bottom rail of the shade.]**

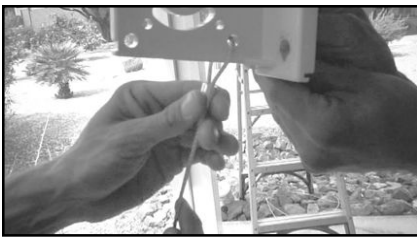

Pull cable tight and create small tight loop around turnbuckle eye. Use swaging tool to crimp cable sleeve onto cable. Repeat this whole process on the other side.

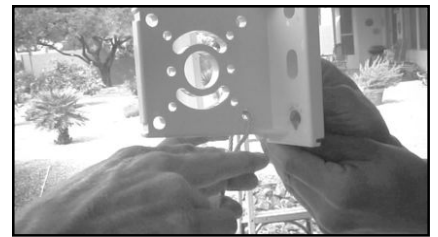

6. Safety Wire Turnbuckles

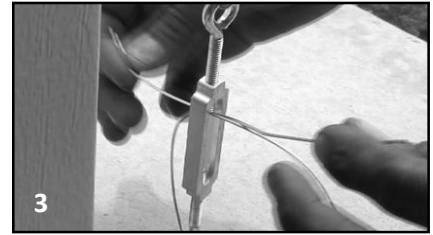
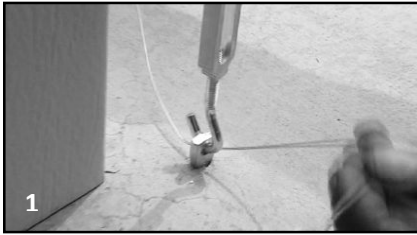

Using left over cable, unravel two strands of wire about 10" in length. Weave strands of wire through tie wire, turnbuckle and then cable loop. Use pliers to twist wire tight. Cut off excess. This prevents the turnbuckle from twisting and loosening the cables. You will repeat this on the other side.

7. Adjust Motor Limits



[NOTE: Motors come pre-programmed with short limits.] To change the lower limit, send the motor to its current lower limit by pressing the down arrow. Press both the up and down button at the same time until the motor jogs. Adjust to your desired lower limit position and press the "my" button until the motor jogs. This saves your lower limit. To change the upper limit, send the motor to its current upper limit. Press both the up and down buttons at the same time until the motor jogs. Adjust to your desired upper limit position and press the "my" button until the motor jogs. This saves your upper limit.

8. Confirm Limits

Send the shade to both the upper and lower limits. The shade should roll up and down on cable guides and stop on its own at the programmed limit settings. You're done!